

# River City Supply

## Washout Booth Instructions

Note: Leave bolts hand tight until washout booth is fully assembled. Then go through and fully tighten.

### Whats In The Box:

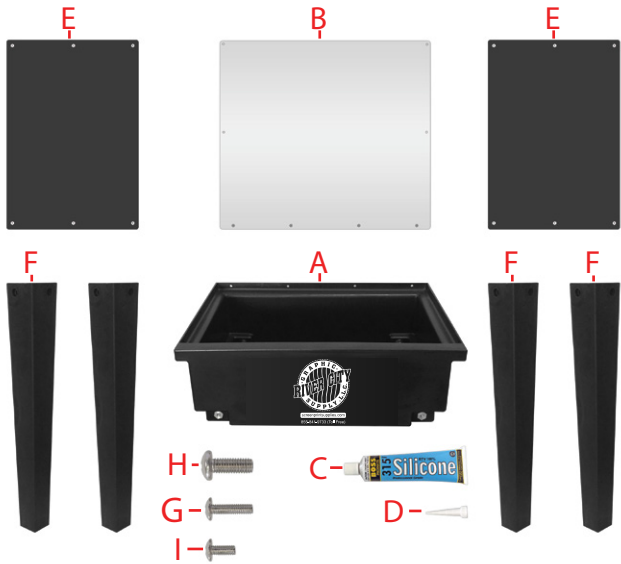

- A** 1 - Sink Pan
- B** 1 - Translucent Back panel
- C** 1 - Tube of Silicone
- D** 1 - Silicone Applicator Tip
- E** 2 - Side Panels
- F** 4 - Legs
- G** 4 - 1/4"-20 x 1" SS Pan Head Bolt
- H** 8 - 3/8"-16 x 1" SS Pan Head Bolt
- I** 10 - 1/4"-20 x 3/4" SS Pan Head Bolt

**Tools Required:**

- Phillips Screwdriver



- 1**
- Take the sink pan and turn it upside down.
  - Attach one leg at a time using two (**H**) bolts and a phillips screwdriver. **(DO NOT OVER TIGHTEN!)**
  - Repeat the process for the other three legs.



- 2**
- Stand the sink upright on all four legs.
  - Attach one side panel to the inside of the sink pan using three (**I**) bolts. **(DO NOT OVER TIGHTEN!)**
  - Note: Threaded inserts on the side panels should face the back of the sink.
  - Repeat the process for the other side panel.

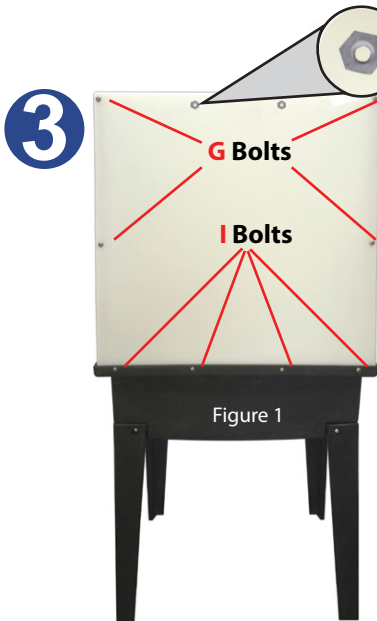

- 3**
- Inserts for light kit upgrade
  - Attach the translucent back panel to the bottom of the sink pan using four (**I**) bolts. **(DO NOT OVER TIGHTEN!)**
  - Apply a thin bead of Silicone to the back of both side panels. (See Figure 2 marked in **Red**)
  - Attach the translucent back panel to the side panels using four (**G**) bolts. **(DO NOT OVER TIGHTEN!)**



- 4**
- Move sink to your desired Location.
  - Connect drain to 1-1/2" female coupler on sink per city and county regulations.

